

National Erebus Memorial



Looking Out

Perspective looking over the memorial towards Rangitoto and Maungaika (North Head)



Looking Back

Perspective looking back to the walls and the names of the passengers



Legend

- ① Waharoa marks the entry points into the site
- ② Snow white walls form terraces with the family members names
- ③ Pōhutukawa sits over site
- ④ Basalt black paths carry the words of the families and karakia, guiding visitors through the memorial
- ⑤ Open spaces allow for families to gather together on entry and look to Takaparāwhau and Rangitoto
- ⑥ Between the walls and the paths planting creeps along the ground plane and up the walls softening the site and journey
- ⑦ The sides of the memorial are nestled in rich and diverse sweeps of coastal natives
- ⑧ Small informal paths through planting allow visitors to come and go with ease
- ⑨ Ramps ensure all parts of the memorial are accessible to all
- ⑩ Steps run along the edges of the memorial allow permeability through the site
- ⑪ Seating areas feature crafted 'ice floe' forms of solid timber blocks. These provide a range of options for small and larger groups to be together
- ⑫ Lawn areas outside of the memorial create informal gathering areas
- ⑬ Crew are acknowledged together to recognise their role in service
- ⑭ Words acknowledge the recovery team and the many others who came together to help in the aftermath
- ⑮ Mauri Stone from Ross Island
- ⑯ Floating wooden platform with views back into the memorial as well as to the Waitemātā
- ⑰ New paths connect with existing cliff top walkway



Context - Views, Movement and Entries



Site - Views, Movement and Circulation



Materiality - Walls & Names

The terraced walls carrying the names of the families are made of a snow white concrete emulating the snow and ice of Erebus. The walls capture the changing light making them an ever moving canvas for the sky. At night cool tinted Led washes will create an ice like quality beneath the moonlight.

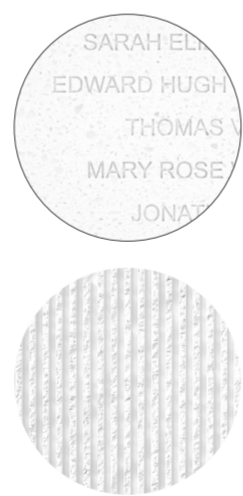

Materiality - Planting

Plant material is locally sourced and grown in Tamaki working with Okahu Rakau who specialise in growing a diversity of plants specific to the region. Planting layers create a soft green contrast to the walls and paths.

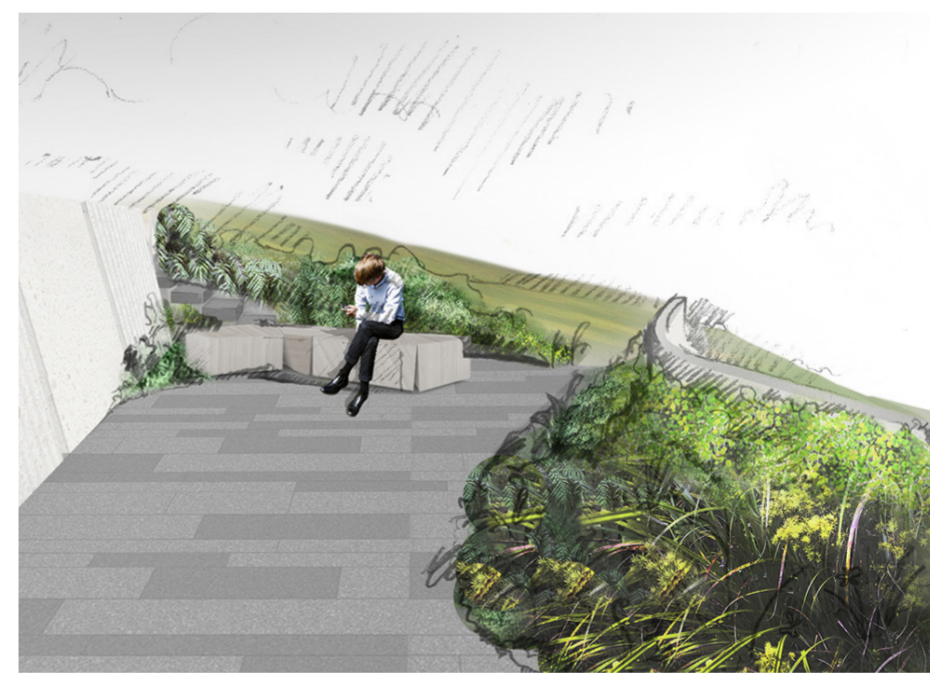

Materiality - Paths & Stone

Basalt black concrete paths emulate the volcanic geology of Ross Island and sit shadow like beneath the walls and through the planting. On the surface of these, karakia and the human story in the words of the families are sandblasted. The mauri stone is sourced from Ross Island.



Materiality - Seating

The seating is carved from large blocks of hardwood which sit together like ice floes. It is provided for at all levels of the memorial to allow the space to be used and enjoyed by many. The textured surface will be left to naturally silver with age.

